

EXT. ELEV.
2/A-3

EXT. ELEV.
3/A-3

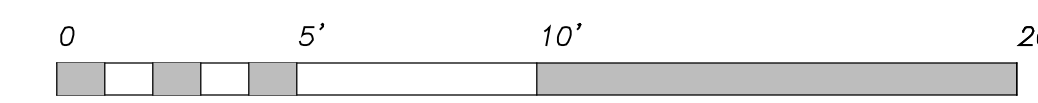
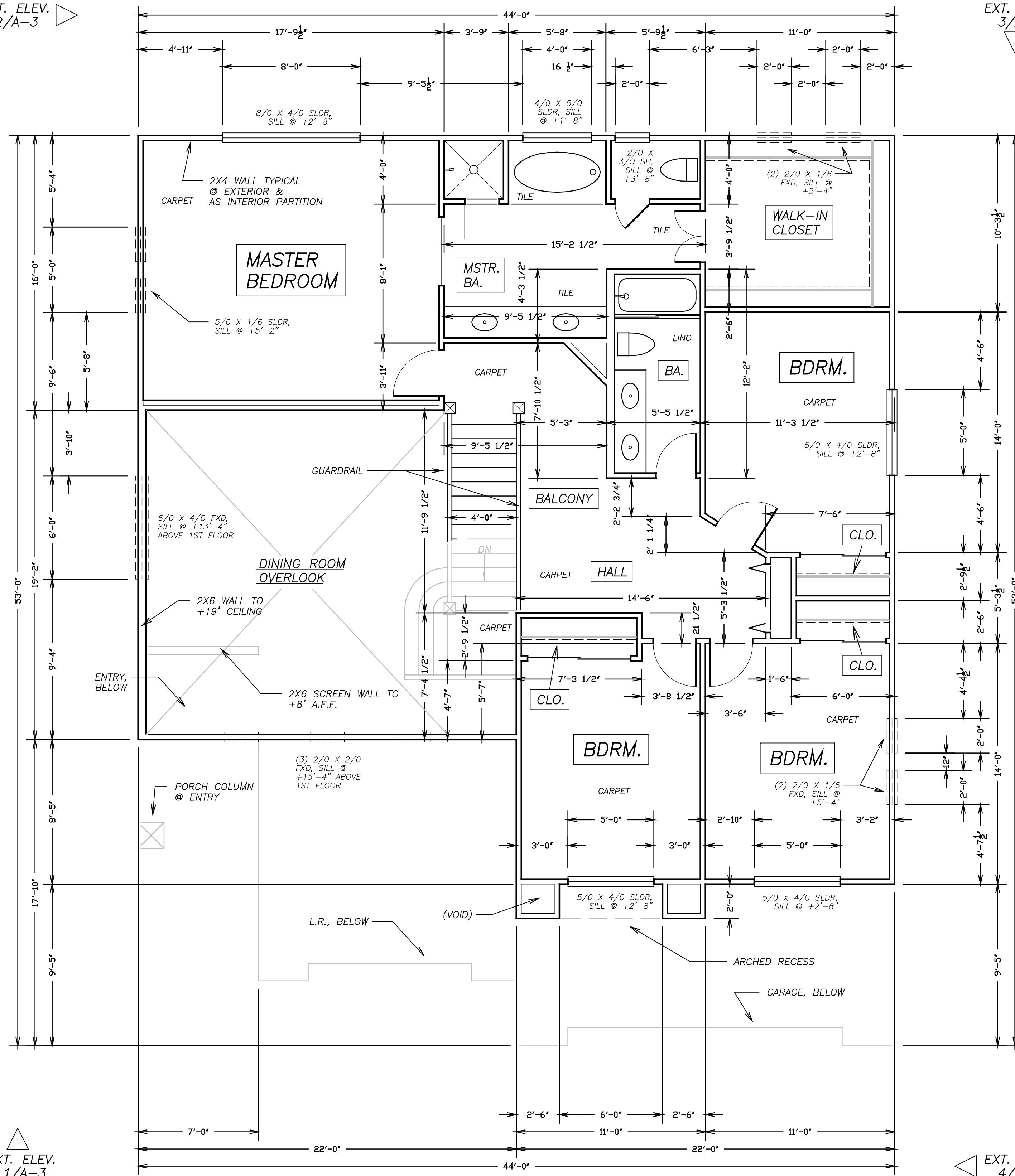

SECOND FLOOR ARCHITECTURAL PLAN
SCALE: 1/4" = 1'-0"

STAIRWAY REQUIREMENTS:
THE RISE OF STEPS IN A (PRIVATE) STAIRWAY (SERVING AN OCCUPANT LOAD OF LESS THAN 10) SHALL NOT BE LESS THAN 4" OR GREATER THAN 8", AND THE RUN SHALL NOT BE LESS THAN 9". THE GREATEST RISER HEIGHT WITHIN ANY FLIGHT OF STAIRS SHALL NOT EXCEED THE SMALLEST BY MORE THAN 3/8". THE LARGEST TREAD RUN WITHIN ANY FLIGHT OF STAIRS SHALL NOT EXCEED THE SMALLEST BY MORE THAN 3/8".

STAIR SPECIFICATIONS:
OF RISERS = 18
INDIVIDUAL RISE = 6 5/8"
TOTAL RISE = 9'-11 1/4"
TYPICAL TREAD LENGTH = 10"
TOP OF GUARDRAIL @ +42" ABOVE DECK. DESIGN OF GUARDRAIL SUCH THAT A 4" DIA. SPHERE CANNOT PASS BETWEEN MEMBERS.
PROVIDE 1-1/2" DIA. HANDRAIL (CONTINUOUS); TOP @ 34" ABV. STAIR NOSING.

SAFETY GLAZING:
ALL GLAZING WITHIN A 24" ARC OF EITHER VERTICAL EDGE OF A DOOR IN CLOSED POSITION AND WHICH IS WITHIN 60" (VERT.) OF THE WALKING SURFACE SHALL BE SAFETY GLAZED. GLAZING IN FIXED OR OPERABLE WINDOWS WHICH ARE MORE THAN 9 SQ.FT. & ARE WITHIN 18" OF THE FLOOR ARE ALSO TO BE SAFETY GLAZED.

EGRESS WINDOWS:
BASEMENTS IN DWELLING UNITS AND EVERY SLEEPING ROOM BELOW THE FOURTH STORY SHALL HAVE AT LEAST ONE OPERABLE WINDOW OR EXTERIOR DOOR APPROVED FOR EMERGENCY ESCAPE OR RESCUE WHICH OPENS DIRECTLY ONTO A PUBLIC STREET, PUBLIC ALLEY, YARD, OR EXIT COURT. MIN. NET CLEAR OPENABLE AREA FOR SAID WINDOW SHALL BE 5.7 SQ.FT.; MIN. NET CLEAR OPENABLE HEIGHT DIMENSION SHALL BE 24"; MIN. NET CLR. WIDTH DIM. SHALL BE 20"; SILL HEIGHT SHALL BE 44" MAX.

HEARTH EXTENSION: HEARTH SHALL EXTEND AT LEAST 16" IN FRONT OF, AND BEYOND EACH SIDE OF, THE FIREPLACE OPENING. WHERE A FIREPLACE IS 6' SQ. OR LARGER, THE HEARTH SHALL EXTEND AT LEAST 20" IN FRONT OF, AND AT LEAST 12" BEYOND THE SIDE OF, THE FIREPLACE OPENING.
COMBUSTIBLE MATERIALS SHALL NOT BE PLACED WITHIN 6" OF THE FIREPLACE OPENING. COMBUSTIBLE MATERIAL WITHIN 12" OF THE FIREPLACE OPENING SHALL NOT PROJECT MORE THAN 1/8" FOR EA. 1" CLEARANCE FROM SUCH OPENING.

PROVIDE TUB/SHOWER WITH PRESSURE BALANCE OR THERMOSTATIC MIXING-VALVE CONTROLS PER 2001 C.P.C., SECTION 420.