

EXT. ELEV. 3/A-4

EXT. ELEV. 4/A-4

EXT. ELEV. 2/A-4

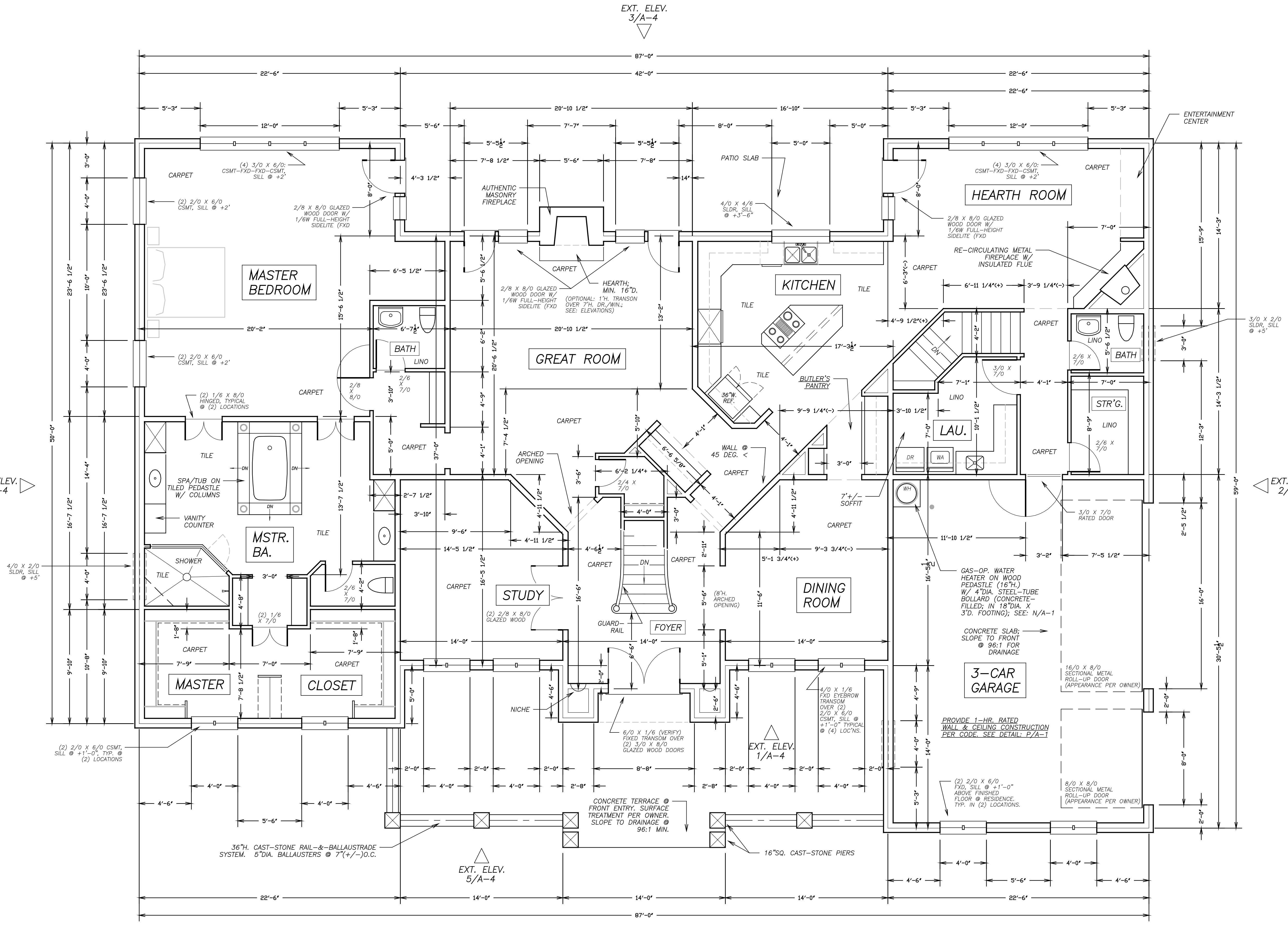

STAIR SPECIFICATIONS  
 (FOR MAIN & SIDE STAIRWAYS):  
 TYPICAL RISE = 7 3/4" (7 45/64")  
 TOTAL RISE = TYP. X 18 = 11'-6 5/8"  
 TYPICAL TREAD WIDTH = 10"

**FIRST FLOOR ARCH'L. PLAN**  
 SCALE: 1/4" = 1'-0"

+10' CEILING TYPICAL @ 1ST FLOOR

